

Software revisions :

- V3.01First Release
- V3.02.....Relay Time values modified
- V3.03.....SD Card Time / Date stamping added
- V3.04.....Test Key code added
- V3.05.....Boot loaded added

Complex Gate Receiver

Model: COMPLEX_RX_V3

- 2 Channel receiver, 8000 remotes total capacity, real time clock, 2000 Events internal, microSD card, USB 2.0, GSM connectivity.

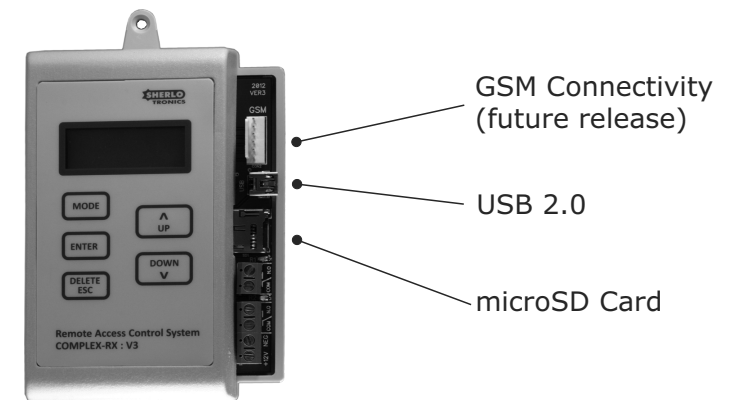

Contents

1	Description of functions and features.....	pg 2
2	Specifications.....	pg 2
3	Wiring diagram.....	pg 3
4	Learning in Remotes.....	pg 4
5	Deleting remotes from the unit.....	pg 5
6	Setting the time & date.....	pg 6
7	Setting the Relay contact closure time.....	pg 7
8	Changing the Password.....	pg 8
9	Viewing the event log.....	pg 8
10	Saving to the microSD card.....	pg 9
11	Installing a Saved backup from a microSD card.....	pg 10

Thank you for purchasing our latest model Complex gate access control receiver. We hope your installation experiences many years of trouble free remote control.

This device is covered by a 3 year manufactures warranty. If you have any electrical trouble with the device, please send it in to our technical department and it will get attended to the problem within 24 Hours.

Please carefully follow the installation manual to install the unit and get familiar with its operating functions.

Please note that the new model unit is backward compatible to the older ver 2 unit. This means that you can unplug the 25LC1024 eProm memory IC from the older model and plug it into this new VER3 model and your remotes will still operate.

The software application that is supplied in this package will only work with this new VER 3 model and will not work on the older model.

We trust that you will find it straight forward enough to program and setup. If you have any questions or technical advice please phone our technical division on 011 462-5101.

Installing the Remotes backup file.

If you need to install a new unit due to a product been struck by lightning or if an electrical malfunction occurred, please follow this guide in successfully install all the remotes back into the replacement unit.

Insert a microSD card into your pc, and make sure it is formatted as a FAT32 file system. Now copy just the backup file you saved and make sure it is still called : **BACKUP.txt**

Now insert the microSD card into the units onboard card holder and follow the steps below:

1. Press the MODE Button until the screen displays **INSTALL MODE**
2. Press ENTER. The unit will prompt you for a password.
3. Using the UP/DOWN keys enter the PASSWORD
The default is **1;2;3;4.**
4. Press ENTER for each digit.
5. Press the UP/DOWN key to find **INSTALL BACKUP**
6. Press ENTER.
7. The unit will say: BUSY STORING. This takes 1 minute to complete.
8. To EXIT out of the **INSTALL BACKUP** mode press the MODE button. Then press the Down button till **EXIT MODE** displays. Then press ENTER.

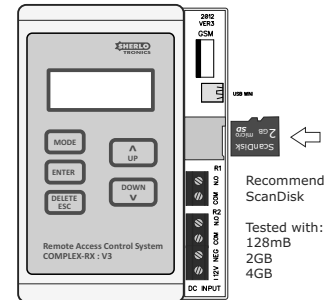

Please note:

The unit will not have any history of the events that were logged on the previous. We do not cater for Installing old events back into a unit. Any new events will be stored on the new units eProm as they occur.

Description of Functions and Features

Saving to the microSD card

A microSD card must first be formatted to a FAT32 File system.

Carefully plug the card into the card holder. The display will ready **SD Card inserted**.

To make a backup to the microSD card follow the steps below:

Press the MODE button twice or till the display says **SAVE TO SD CARD**. Press ENTER. The display will say, **Busy Writing**. This takes approx 40s to complete.

You may now remove the card. The display will say, **SD Card Ejected**.

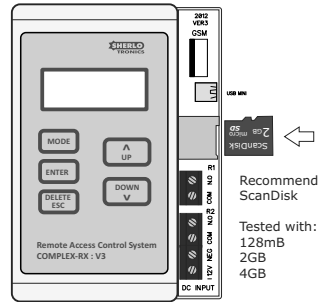

1. The **Complex-Rx_VER3** unit can Store up to 4000, Sherlotronics Code-hopping remotes per relay, that is a total of 8000 into its memory. The memory starts from UNIT 1 to 500. Each UNIT can be programmed with up to 8 users. The Users are letters starting from A to H. The Table below shows how the units memory mapping works.
2. The Complex-RX_V3 can save up to 2000 time & date stamped Events to its internal memory. Each event that is saved will show the Remote no; Time; Day; and Month.
3. The unit is password protected for accessing functions such as learning in or deleting remotes, setting the time & date, changing the password, or installing a backup to the system.
4. The unit can be connected to a PC via a standard USB 2.0 port to down-load its events, install a backup file, set independent timers, and create a Data base to register each remote control to a residents personalised details.
5. The Computer application Software is available on line at:- www.sherlotronics.co.za
6. A standard microSD card will allow you to backup the units entire memory which includes the remote that were learnt in and the previous 2000 event log, as well as Install a previously saved backup file to a new Complex-Rx_V3 unit.

Memory mapping table:

Unit	User 1	User 2	User 3	User 4	User 5	User 6	User 7	User 8
1	A	B	C	D	E	F	G	H
2	A	B	C	D	E	F	G	H
↓								
500	A	B	C	D	E	F	G	H

Once you have inserted microSD card into a pc, with either a SD Card adaptor or USB multi adaptor open the file. There should be (3) two folders called: **EVENTS.txt** ; **BACKUP.txt** and **2000.txt**

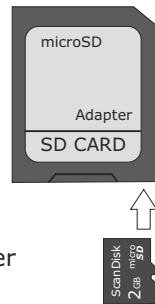

We recommend that you look at saving these three files in a folder or safe place for future use. Please do not alter the file names or information within the files in any way or this will corrupt the backup.

Note:

The unit will auto Exit out of this mode if no key is pressed after 30 seconds.

Specifications

Encryption.....Keeloq, Code-Hopping
 Frequency..... 403.55Mhz
 Range : Line of site..... 100m
 Voltage range..... 10 - 14 Volt DC
 Current drain..... 80mA, 12VDC
 Relay output's..... 1 to 10 sec momentary
 Temperature..... -7° C ~ +65° C
 Dimensions..... 116 x 84 x 35mm
 Software version:.....Ver 3:01
 Release date:.....March 2012

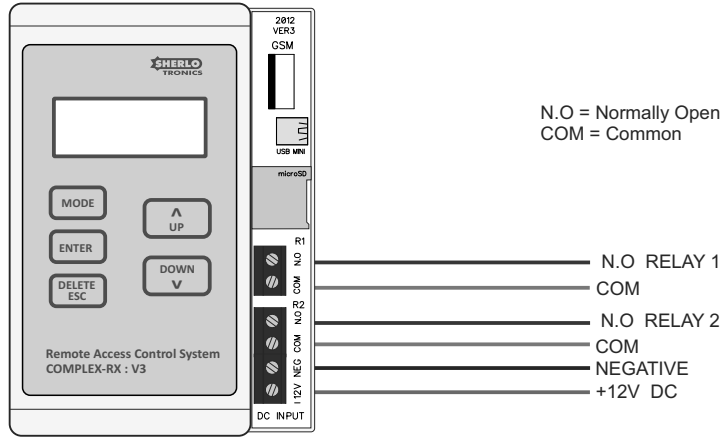

This diagram serves as an example of a typical gate motor wiring

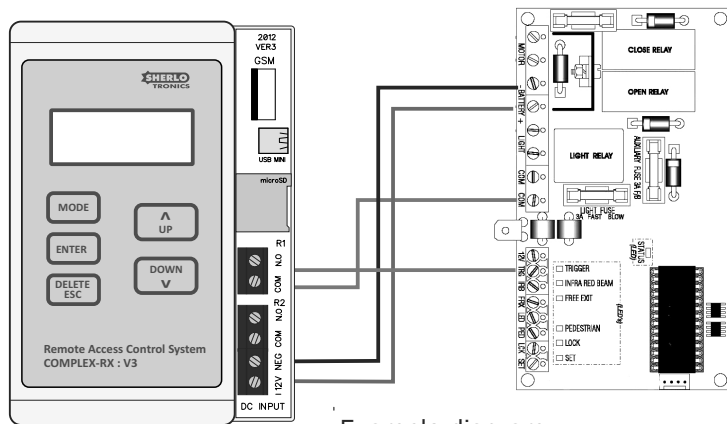

Example diagram

Changing the password

1. Press the MODE Button until the screen displays **INSTALL MODE**
2. Press ENTER. The unit will prompt you for a password.
3. Using the UP/DOWN keys enter the PASSWORD. The default is 1;2;3;4.
4. Press ENTER for each digit.
5. Press the MODE key to find **SET PASSWORD**
6. Press ENTER.
7. Scroll UP / DOWN to a set the digit
8. Press ENTER to save the setting.
9. To EXIT out of the **SET PASSWORD** mode press the MODE button. Then press the Down button till **EXIT MODE** displays. Then press ENTER.

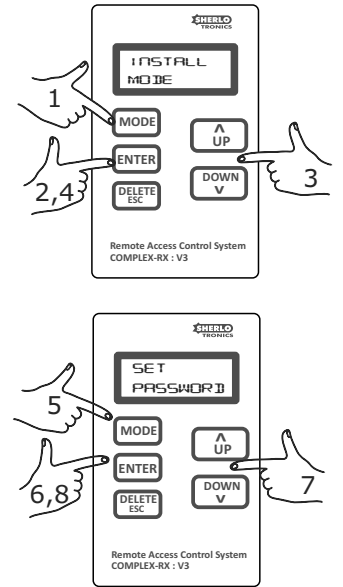

View the Event Log

1. Press the MODE Button once. The screen displays **VIEW EVENTS**
2. Press ENTER. The unit will display the time / date it received an activation.
3. Press the DOWN key to view the UNIT/ USER and the RELAY that was triggered.
4. Continue with step 3 pressing the DOWN key to view each event one at a time.
5. To EXIT out of the **VIEW EVENTS** mode press the MODE button till the display show the current time & date screen.

Note:

The unit will auto Exit out of this mode if no key is pressed after 30 seconds.

Setting the Relay time

1. Press the MODE Button until the screen displays **INSTALL MODE**
2. Press ENTER. The unit will prompt you for a password.
3. Using the UP/DOWN keys enter the PASSWORD. The default is **1;2;3;4.**
4. Press ENTER for each digit.

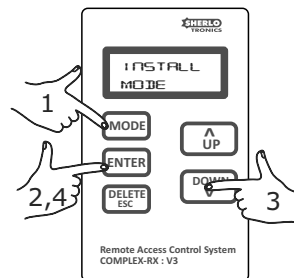

5. Press the UP/DOWN key to find **RELAY TIME**
6. Press ENTER.
7. Scroll UP / DOWN to a set the required digit
8. Press ENTER to save the setting.
9. To EXIT out of the **RELAY TIME** mode press the MODE button. Then press the Down button till **EXIT MODE** displays. Then press ENTER.

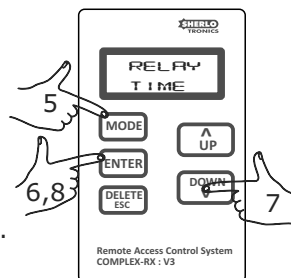

Note:

Both relays are globally programmed to switch between 1 - 10 Seconds. Some gate motors require a longer or shorter trigger input, so the relay settings may be programmed accordingly to motor you are connecting this unit. The Complex Rx_V3 is factory set to 1.0 Second.

Learning in Remotes

1. Press the MODE Button until the screen displays **INSTALL MODE**
2. Press ENTER. The unit will prompt you for a password.
3. Using the UP/DOWN keys enter the PASSWORD. The default is 1;2;3;4.
4. Press ENTER for each digit.
5. Press the MODE key to find **LEARN / DELETE**
6. Press ENTER. The display will read : **UNIT 1A / RELAY 1**
7. Scroll UP / DOWN to a UNIT no you wish to program. To switch between RELAY 1 & 2 press the UP & DOWN keys quickly together.
8. Press the ENTER button if you wish to program the remote TX into the unit. The unit will display, **Press now.**
9. Activate the remote TX. The unit will display, **Press again.** Once the remote TX is learnt in a *star will display on the bottom right hand of the screen.

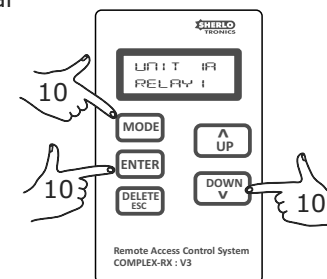
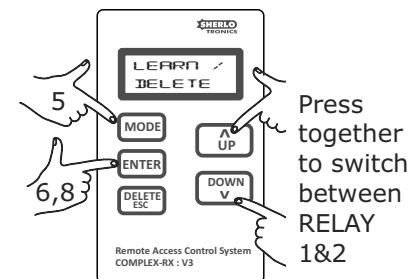
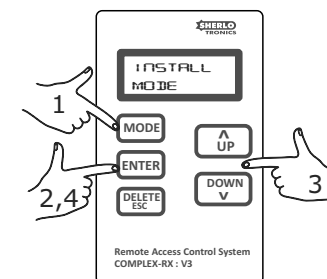

10. To EXIT out of the **LEARN/DELETE** mode press the MODE button. Then press the Down button till **EXIT MODE** displays. Then press ENTER.

Deleting Remotes

1. Press the MODE Button until the screen displays **INSTALL MODE**
2. Press ENTER. The unit will prompt you for a password.
3. Using the UP/DOWN keys enter the PASSWORD
The default is 1;2;3;4.
4. Press ENTER for each digit.

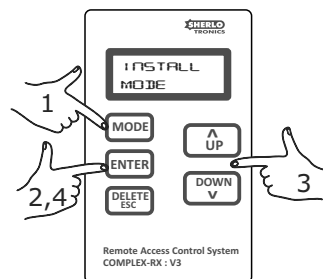

5. Press the MODE key to find **LEARN / DELETE**
6. Press ENTER. The display will read :
UNIT 1A / RELAY 1
7. Scroll UP / DOWN to a UNIT no you wish to Delete. To switch between RELAY 1 & 2 press the UP & DOWN keys together.

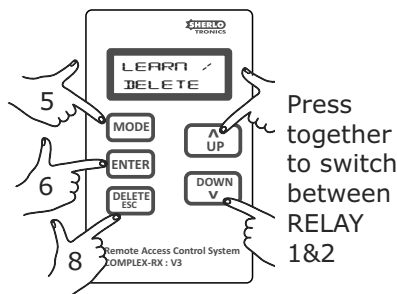

8. Press and HOLD the DELETE key if you wish to Delete the remote TX from the unit. The unit will say **DELETING REMOTE**, after 3 seconds The *star will no longer be on the bottom right side of the screen.
9. To EXIT out of the **LEARN/DELETE** mode press the MODE button. Then press the Down button till EXIT MODE displays. Then press ENTER.

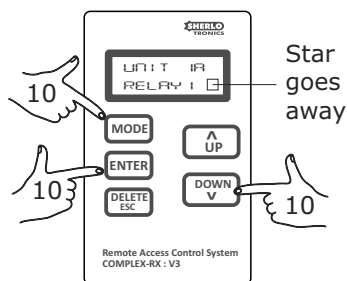

Please note:

If you release the Delete key for a short time the remote TX will not be erased.

Setting the Time & Date

1. Press the MODE Button until the screen displays **INSTALL MODE**
2. Press ENTER. The unit will prompt you for a password.
3. Using the UP/DOWN keys enter the PASSWORD
The default is 1;2;3;4.
4. Press ENTER for each digit.

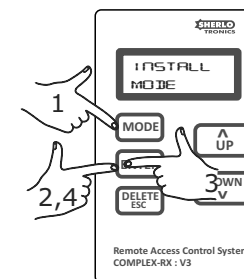

5. Press the MODE key to find **SET TIME** or **SET DATE**
6. Press ENTER.
7. Scroll UP / DOWN to a set the required digit
8. Press ENTER for each setting.
9. To EXIT out of the **SET TIME** or **SET DATE** mode press the MODE button. Then press the Down button till **EXIT MODE** displays. Then press ENTER.

