

# WIRELESS MIMIC BASE

Part No:

- **MB3000**  
Version 1



# TABLE OF CONTENTS

Applications, Specifications & Features .....	1
Wiring Diagram .....	2
Connecting the Superheterodyne Data Receiver .....	2
Mounting Hints .....	2
Connecting Power to the Unit .....	3
Connecting the Relay Outputs .....	3
Programming Remotes into the Unit .....	4
Deleting Remotes from the Unit .....	5
Setting the Date and Time .....	5
Setting up Parameter Configurations .....	5
Setting up Relay Output Times .....	5
Connecting the Dot Matrix Printer .....	6
Troubleshooting / Important Note.....	6
Operation Explained .....	7
Testing the Relay Outputs .....	7
Software upgrades and versions done.....	8

## PLEASE NOTE

The information contained in this document is subject to change without notice. Sherlotronics makes no warranty of any kind with regard to this material, including, but not limited to, the implied warranties of merchantability and fitness for a particular purpose.

Sherlotronics shall not be liable for errors contained herein or for incidental or consequential damages in connection with furnishings, performance, or use of this material.



# WIRING DIAGRAMS

## Connecting the Superheterodyne Data Receiver

It is recommended that you use screened cable.

Do not install the cable close to any of the following:

- Mains Cables
- Computer Data Network Cables
- Electric Fence HP Cables

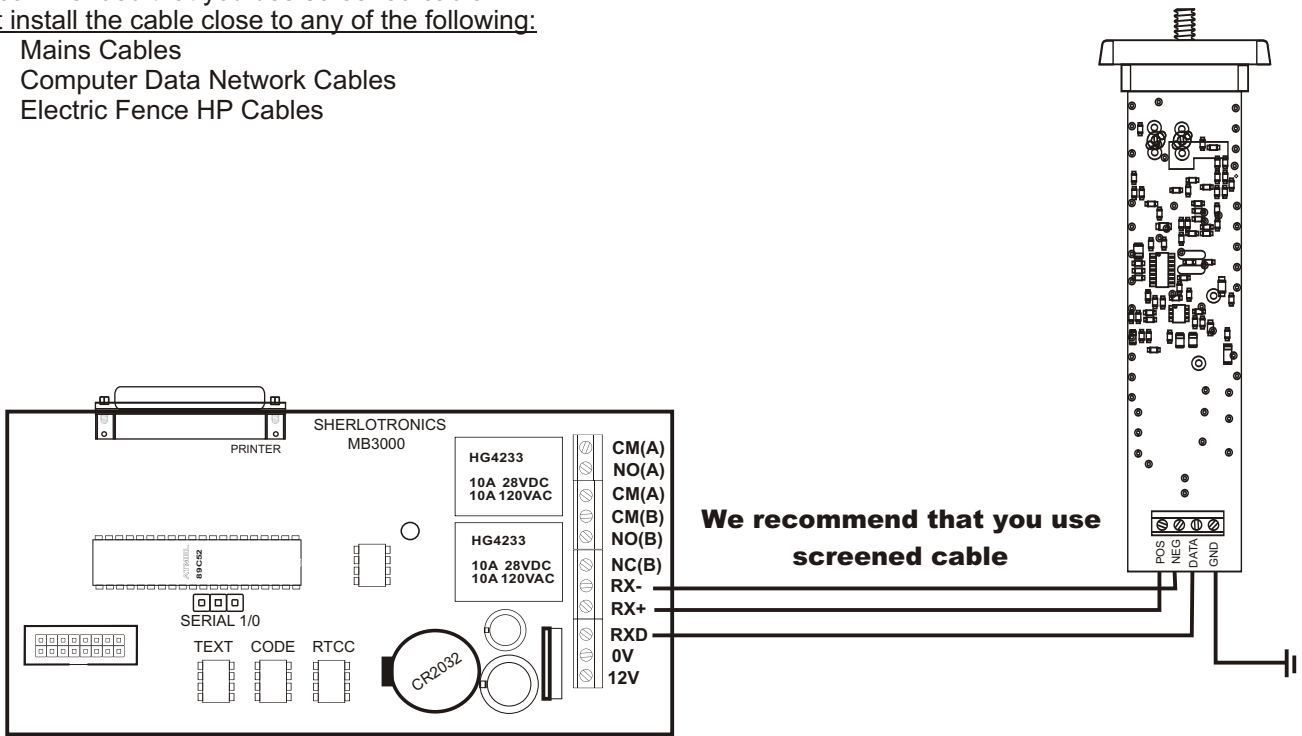

## Mounting Hints



### DO NOT:

Mount the Data Receiver up against or next to the Metal Chassis of the MB3000. This may lead to reduced range and poor sensitivity. The Data Receiver unit is designed to be mounted away from the MB3000.

For the best possible range, mount the Superheterodyne Data Receiver as high as possible.

Use a good quality screened cable. Do not run more than 100m.

Avoid running the cable near electric fence wires or HT cables.

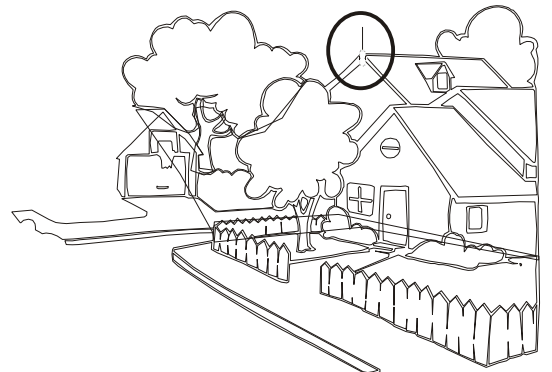

# WIRING DIAGRAMS

## Connecting Power to the Unit

If the unit was not ordered with a SHERLOTRONICS' Power Supply, we recommended that you use a good quality 1.5 Amp 12V DC regulated Power Supply with Battery Back-Up.

Order code for Power Supply: **1.5AMP**

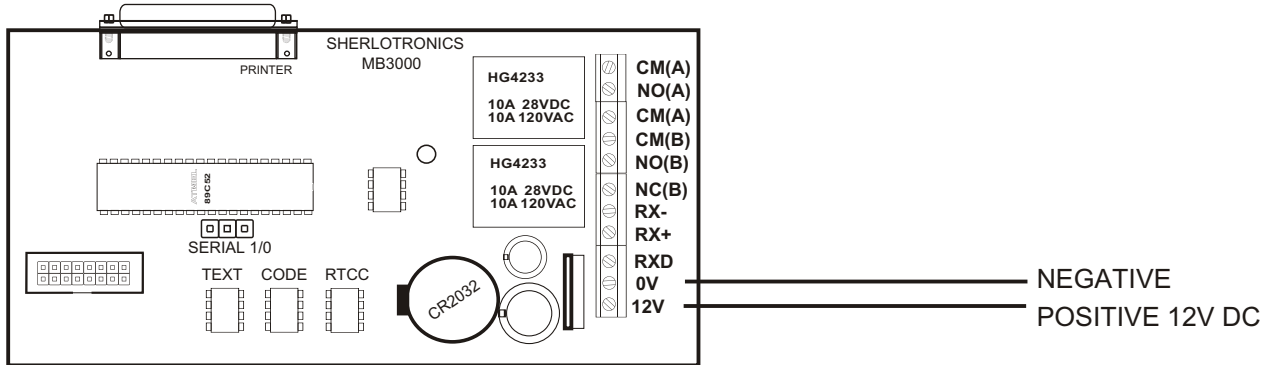

## Connecting the Relay Outputs

The Relay Outputs are both Potentially free.  
 The Outputs may be programmed to switch from 1 to 240 seconds respectively. Refer to **SUPERVISOR** mode.  
**Typically:** **Output A** can be used to switch a Radio Transmitter and **Output B** may be used to activate a Siren.

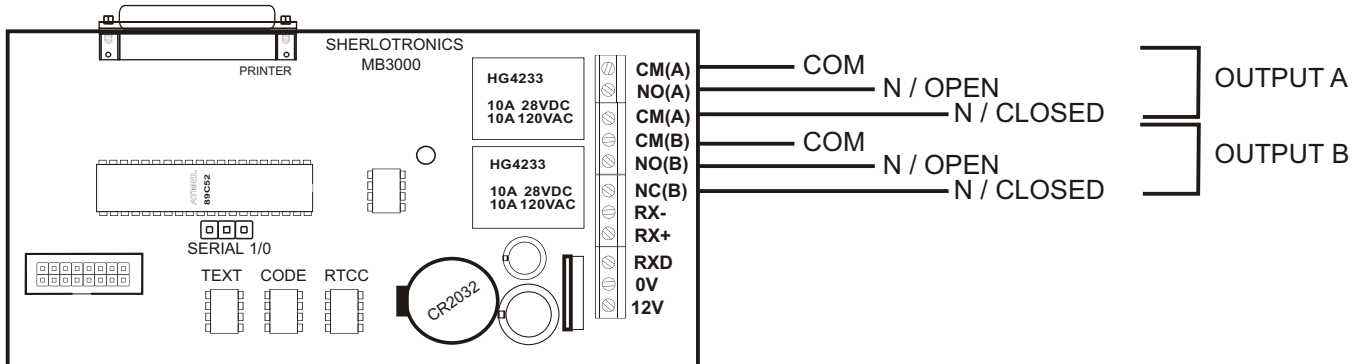

**Default settings are:**  
 Output A : 2 seconds  
 Output B : 180 seconds

## Programming Remotes to the unit “Sto”

- 1 Press and Hold the **SECRET SUPERVISOR** mode button for +/- 10 Seconds until the unit enters into Supervisor mode, as shown.
- 2 Press the button below: **[3] (STORE / ERASE)**.
- 3 Press the button below **[1] Signal**
- 4 Pressing the **+1** button will increase the unit from Channel 000 to Channel 001, ie: increment the Channels by one.
- P Pressing the **+10** button will increment the Channels by 10 at a time. A maximum of 999 Channels are programmable.
- 5 **To Store a remote into a Channel**, press and hold in the **Sto** button on the Mimic Base. The Mimic Base will display: **Waiting for signal...** Whilst holding down the **Sto** button you must transmit the signal be stored.  
Once the unit has stored the remote, a star (\*) will appear on the far right hand side of the screen indicating that a code is stored in memory.
- 6 P Press **EXIT** to return to **SUPERVISOR** mode.

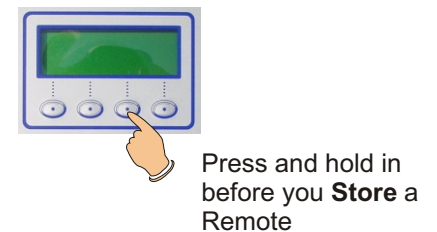

### PLEASE NOTE:

The unit auto exits if no commands are given after 30 seconds.

A remote that is programmed into Channel 000 will operate as a Silent Panic if E is on in the configuration mode - refer to Page 5 “Setting up different Parameter Configurations”.

## Deleting Remotes from the unit “Clr”

- Press and Hold the **SECRET SUPERVISOR** mode button for +/- 10 Seconds until the unit enters into Supervisor mode, as shown.
- Press the button below **[3] (STORE / ERASE)**.
- Press the button below **[1] Signal**
- Pressing the **+1** button will increase the unit from Channel 000 to Channel 001; ie: increment the Channels by one.
- Pressing the **+10** button will increment the Channels by 10 at a time. A maximum of 499 Channels can be pre-programmed.
- To Erase a remote from memory, press the **Clr** button. The star (\*) on the far right hand side of the screen will disappear.
- Press **EXIT** to return to **SUPERVISOR** mode.

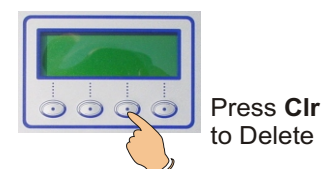
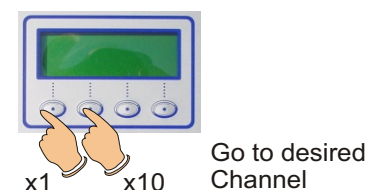
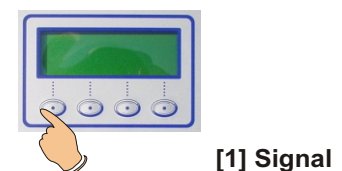

## Setting the Date and Time

- Press the **Set** button - the **USER SETUP** screen appears.
- Select either **Time** or **Date**.

### For TIME Setup:

- Press the **Up** or **Dn** (Down) button to increase or decrease the hour.
- Press the **Next** button to select the minutes. The **^ ^** indicates the selection.
- Press **Ok** when finished.
- Press **EXIT** to return to the Normal screen.



**Set**  
Button

### For DATE Setup:

- Press the **Up** or **Dn** (Down) button to increase or decrease the year.
- Press the **Next** button to select the month followed by days. The **^ ^** indicates the selection.

## Setting up Parameter Configurations [1]

- Press and Hold the **SECRET SUPERVISOR** mode button for +/- 10 Seconds until the unit enters into Supervisor mode, as shown.
- Press the button below **[1]**.
- Press the button below **[1]** again.
- To enable or switch ON a configuration, the applicable letter must appear as a Capital Letter. If you want the configuration OFF, then the letter must appear in Lower Case.

### Configuration Letters explained:

	<u>ON</u>	<u>OFF</u>
Print when signals are received	<b>P</b>	<b>p</b>
Response Printout when reset	<b>R</b>	<b>r</b>
RS232 Logging Output	<b>S</b>	<b>s</b>
24-Hour Silent Test Output & 14:15	<b>T</b>	<b>t</b>
Ch 000 Silent Panic Output	<b>E</b>	<b>e</b>
Display Custom Pre-Programmed Text	<b>N</b>	<b>n</b>
Buzzer Key - Beep	<b>B</b>	<b>b</b>
Computer Communication for Text editing	<b>C</b>	<b>c</b>



**Secret**  
**Supervisor Mode**  
Button



**[1] Params**



**[1] Configuration**

## Setting up Relay Output Times

- Press and Hold the **SECRET SUPERVISOR** mode button for +/- 10 Seconds until the unit enters into Supervisor mode, as shown.
- Press the button below **[1]**.
- Press the button below **[2]**.
- The **^ ^ ^** indicates the selected time. The **Up** increases the time and the **Dn** decreases the time.
- To select the other Relay Output, press the **Next** button.
- Relay outputs A and B can be individually setup.
- The time increments are in seconds - from 1 to 240 seconds (4 minutes) maximum.
- The Default settings are - **Output A: 002**      **Output B: 240**
- Press **Ok** when done.
- Press **EXIT** to return to **SUPERVISOR** mode.



**Secret**  
**Supervisor Mode**  
Button



**[1] Params**



**[2] Output Timing**

## Connecting the Dot Matrix Printer

Ensure that the MB3000P and Printer unit is off before you commence.  
Carefully open the lid of the MB3000 unit.  
Plug the parallel printer cable to the socket connector on the MB3000 board.  
Feed the printer cable through the slot of the MB3000 metal chassis.  
Close the lid.  
First Apply power to the MB3000 unit.  
Secondly apply power to the Printer, and make sure that it is ONLINE.  
Test by referring to the Supervisor Test Mode, or activating a coded transmitter.

## Important Note

1. Do not mount the Data receiver next to or against the metal chassis. This may cause possible range problems as the internal crystal will interfere with the receiver's sensitivity, thus reducing the receiving range. Refer to mounting hints.
2. Do not mount the MB3000 unit close to an Electric Fence Energizer, 5-25W VHF Radio Alarm Transmitter or 2-Way Radio unit. Mount the Unit at least 2 metres away from these devices.
3. Only use screened cable when connecting the MB3000 to the Data Receiver unit. Inferior cable will affect the range and performance of the unit.
4. Never run power cables and the receiver data cable near HT Electric Fence cables.
5. Ensure that the unit is powered by a reputable 12V DC regulated 1 Amp Power Supply with at least a 7 Amp Battery Back-Up.
6. When connecting either a Strobe, Siren or Radio to the relay output of the MB3000, remember to connect common directly to the battery. Do not use a POS or NEG from the MB3000 Board.

## Troubleshooting

### Basic Troubleshooting

This chapter provides solutions to some possible problems that you may encounter while setting up the MB3000 Mimic Base Control Panel.

### The Unit does not want to program Transmitters

Check that the Data wire is connected correctly to the Terminal blocks in both the base board and the Data Receiver. Also make sure that the Receiver is receiving a transmission by observing the data LED on the PCB.

### The Unit has poor range

Check the location of the Data Receiver. If the unit is mounted central and quite high up, then test if interference is being received. This is done by connecting a 12V Buzzer between the DATA and the NEG leads; ie: connect the buzzer's BLACK lead to NEG and RED lead to DATA. Listen to the noise from the buzzer. If it is sounding loud without you triggering a transmitter, then it is receiving interference. As the receiver has an extremely high performance frequency amplification and a logarithmic signal strength indicator (RSSI), it has a dynamic range in excess of 90dB. It is therefore susceptible to interference even though it has a very narrow bandwidth. Interference can be generated from a very wide spectrum of electrical appliances and equipment. Relocate the receiver as far away from any possible source of interference.

### The Unit does not Print but does read on the LCD Display

Check that the parallel cable is connected securely on either end.  
De-power the unit for 10 seconds and then reconnect the power.  
Check that the **P** is **On** in the Configuration menu.



# Operation of the Unit Explained

## Basic Operation explained

The MB3000 unit will sound the Buzzer and display the applicable Channel or Custom Text when a signal is received by the unit.

The **RST** button on the far right hand side of the screen must be pressed to switch off the Buzzer. This will also reset the Relay outputs.

The screen will then display **Scrl (Scroll)**. This indicates that the unit has memory stored. By pressing the **Scrl** button the **MEMORY** screen appears.

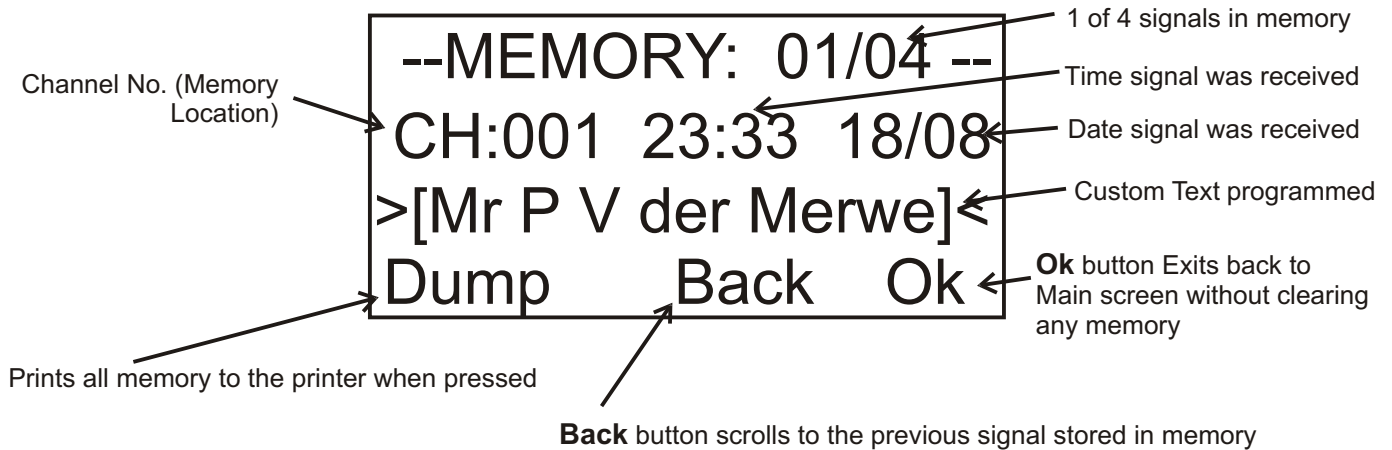

## Testing the Relay Outputs

- Press and Hold the **SECRET SUPERVISOR** mode button for +/- 10 Seconds until the unit enters into Supervisor mode, as shown.
- Press the button below [2].
- Press the **Output A** [1] button to trigger Relay A for 2 seconds to test.
- Press the **Output B** [2] button to trigger Relay B for 2 seconds to test.
- Press the **Printer** [3] button to send a test line to the printer. Ensure that the printer is switched on an ONLINE.
- Press **EXIT** to return to **SUPERVISOR** mode.



**Secret Supervisor Mode Button**



**Test Button**